

# VIVAX

Made for you

D5A 9HB=i? @-A 5'i F9 5>

**HR**

Upute za uporabu



RoHS



NAPOMENA:

**Tvrtka ne snosi odgovornost za moguće probleme prouzrokovane Internetom, Wi-Fi modemom i ostalim napravama. Za dalju pomoć molimo Vas kontaktirate glavnog dobavljača.**

**CS374U-APP(OSK102)  
16122000002774 20151116**



# **SADRŽAJ**

1	IZJAVA O VALJANOSTI.....	1
2	KARAKTERISTIKE.....	1
3	MJERE OPREZA.....	1
4	TEHNIČKA RJEŠENJA.....	2
5	UPUTE ZA UPORABU .....	4
6	KAKO KORISTITI APLIKACIJU.....	13
7	POSEBNE FUNKCIJE.....	15

## **PAŽNJA!**

- Ova naprava u skladu je s pravilnikom br.15, FCC Rules and RSS 210 of Industry & Science Canada. Rukovanje ovom napravom može dovesti do: (1) ova naprava ne uzrokuje štetna međudjelovanja, (2) ova naprava mora prihvatiti bilo kakvo međudjelovanje, pa čak i smetnje koje dovode do neželjenih radnji.
- Koristite napravu samo u skladu s datim uputstvima. Naprava je u skladu sa FCC i IC dozvoljenim količinama zračenja koje vrijede u nekontroliranim uvjetima. Kako bi izbjegli mogućnost pojačanog zračenja, osobe ne bi smjele biti bliže od 20 cm (8 inča) od antene za vrijeme korištenja napravom.
- Bilo kakve preinake i modifikacije koje nisu odobrene od strane proizvođača mogu dovesti do nemogućnosti korištenja opremom..

## **1 IZJAVA O VALJANOSTI**

Ovim putem izjavljujemo da je AC u skladu s osnovnim propisima i ostalim zakonima direktive 1999/5/EC. Vezano uz izjavu valjanosti možete se konzultirati sa prodajnim osobljem.

## **2 KARAKTERISTIKE**

**Model:** OSK102 **Standard:**IEEE

802.11b/g/n

**Vrsta antene:**vanjska usmjerena antena, **Frekvencija:**WIFI:

2.4G**Maksimalna snaga odašiljanja:** 15dBm Max **Dimenzije**

:55\*24\*8(mm)

**Radna**

**temperatura:**0°C~45°C/32°F~113°F.**Vlažnost:**10%~85%**Priključ**

**ak struje::**DC 5V/300mA

## **3 MJERE OPREZA**

•primjenjivi sustav:IOS, Android. (predlaže se i: IOS 7.0 ili Android 4.0) Za više mogućnosti molimo Vas da provjerite stranice glavnog dobavljača.

Izjava o ograničenju odgovornosti: zbog nastajanja posebnih situacija za vrijeme korištenja aplikacije, odgovorno tvrdimo: nisu svi IOS i Android sustavi kompatibilni sa APP. Mi nećemo snositi odgovornost za novonastale situacije zbog nekompatibilnosti bežične sigurnosne strategije vanjske memorije. Vanjska memorija podržava samo WPA-PSK/WPA2-PSK kod. Preporučeni kod je WPA-PSK/WPA2-PSK.

- Smart Phone kamera mora imati 5 milijuna ili više piksela kako bi dobro skenirala QR kod.
- Zbog različitih mrežnih sustava ponekada je potrebno malo vremena kako bi se ponovno konfigurirala mreža.
- U slučaju ponovljenog konfiguriranja mreže obavijest će se pokazati na displeju i APP, pa samo pričekajte.

## **TEHNIČKA RJEŠENJA**

### 1. WIFI Router Home Control način rada

Za taj način rada potreban je Wi-Fi modem. Povežite Smart phone preko AC preko Wi-Fi modema.

1 ) Smart Phone

2 ) Pametni klimatski uređaj

3) " ———— ■ ————"

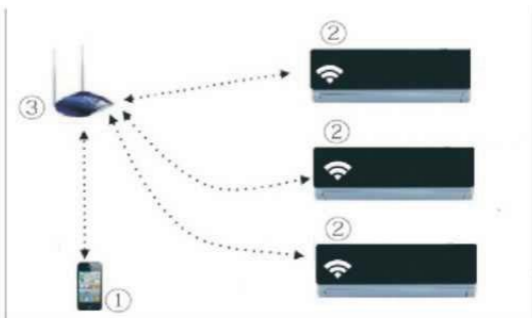

2. kako instalirati vanjsku memoriju.

© skinite zaštitni poklopac sa vanjske memorije.

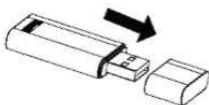

© otvorite prednji poklopac i umetnite prijenosnu memoriju u predviđeni port © Pričvrstite QR kod na bočnu stranu naprave, a pritom pazite kako bi bio dostupan mobilnom telefonu za skeniranje.

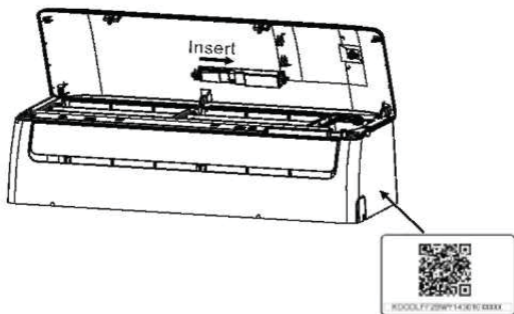

## **5 UPUTE ZA UPORABU**

### **1 .Instaliranje aplikacije**

- 1) **Iphone korisnici:** skenirajte QR kod ili u App Store potražite 'NetHome Plus' aplikaciju i učitajte je.
- 2) **Korisnici Android pametnih telefona:** skenirajte QR kod ili na google play potražite 'NetHome Plus' aplikaciju i učitajte je.

### **2.Namjestite klima uređaj na AP način rada**

Taj postupak zahtijeva slijedeće korake:

- 1) Isključite klimatski uređaj iz utičnice
- 2) Priključite ga ponovno u struju i uzastopno pritisćite na DISPLAY gumb ili DO NOT DISTURB gumb sedam puta u periodu od tri minute.
- 3) Kada uređaj pokaže "AP" znači da je AC Wi-Fi već ušao u mod za podešavanje WI-Fi mreže.

### **Ljubazno podsjećamo:**

- Kada je AC Wi-Fi već ušao u mod za podešavanje Wi-Fi mreže, klimatski uređaj se više ne može otvarati pomoću daljinskog upravljača. Za to treba pričekati 3-5 minuta, ili koliko treba da uređaj završi sa podešavanjem Wi-Fi veze. Tada ponovno možete normalno upravljati uređajem preko daljinskog upravljača.
- ako nema zadane radnje preko Wi-Fi mreže, uređaj se ponovno vraća u prvotno stanje nakon 8 minuta i tada se njime može normalno upravljati.

### 3.Registracija korisnika i konfiguracija mreže

- Svakako provjerite da je vaš mobilni uređaj priključen na Wi-Fi mrežu. Također je bitno da je Wi-Fi modem stupio u vezu sa Internetom prije nego je pokrenuta konfiguracija mreže.



©Kliknite ' Create Account'



© unesite svoju e-mail adresu i lozinku, a zatim kliknite Registration .

## **OPREZ**

U slučaju da zaboravite lozinku, bolje je da se prijavite iz svog inboxa i pokrenete registraciju preko linka.

- Nužno je da se vaša Android ili IOS naprava konektira samo na WIFI mrežu koju želite konfigurirati.
- Uvjerite se da Wi-Fi funkcija vaše Android ili IOS naprave radi ispravno i da se može ponovno automatski konektirati na izvornu Wi-Fi mrežu.

## **I Korištenje android naprave za konfiguraciju mreže**

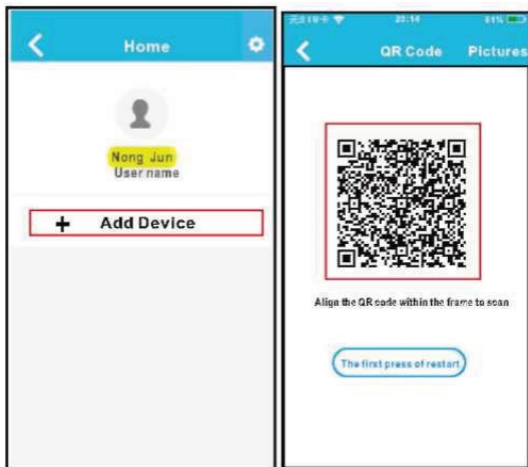

© Pritisnite ' + Add Device'

© Skenirajte QR kod



© Odaberite svoju Wi-Fi mrežu unesite svoju lozinku za Wi-Fi modem i kliknite OK.

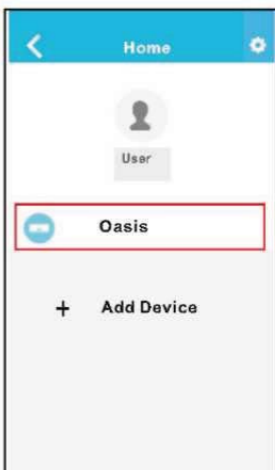

© Ako je konfiguracija bila uspješna, naprava se pojavljuje na vašem popisu.

## Korištenje IOS naprave za konfiguraciju mreže

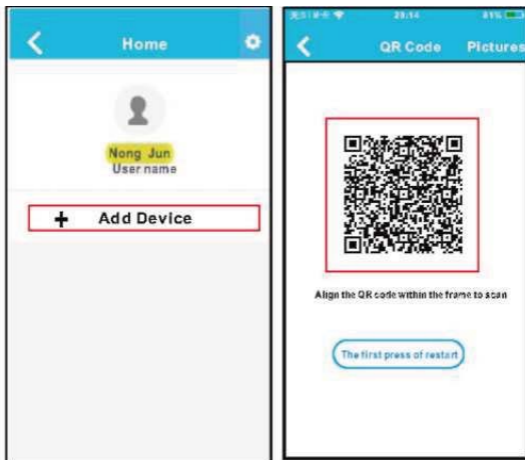

©Pritisnite ' + Add Device"

© Skenirajte QR kod



© Pročitajte upute i pritisnite gumb 'Home' da se vratite u izbornik -.

©Kliknite "Settings" da odaberete stranicu s postavkama i odaberite WLAN/WIFI.



©Odaberite net\_ac\_XXXX



® Utipkajte tvorničku lozinku 12345678 i kliknite "Join "



© Vratite se na APP i kliknite Next

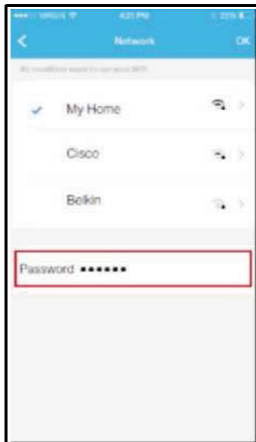

10 Odaberite svoju Wi-Fi mrežu  
 © Odaberite svoju Wi-Fi mrežu unesite svoju lozinku za Wi-Fi modem i kliknite OK.

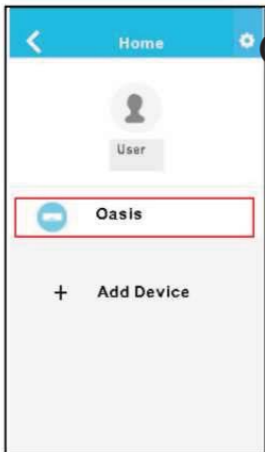

**(2)** Ako je konfiguracija bila uspješna, naprava se pojavljuje na vašem popisu.

### **NAPOMENA:**

Kada je konfiguracija mreže dovršena na ekranu će se pojaviti obavijest. Obzirom na različite Internetske postavke, može se još uvijek pokazivati status "offline". U tom slučaju isključite klima uređaj i ponovno ga uključite. Nakon nekoliko minuta nužno je napraviti "Refresh" kako bi naprava imala "online" status.

## 6 KAKO KORISTITI APP

Prije korištenja aplikacije za upravljanje klima uređajem molimo vas provjerite da su i vaš mobilni telefon i klimatski uređaj spojeni na Internet. Zatim poduzmite slijedeće korake:

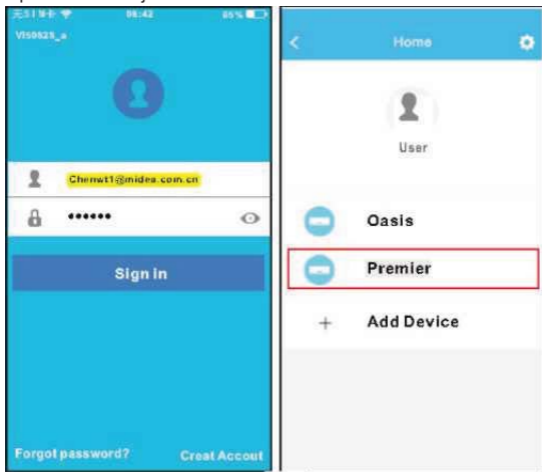

© Upišite svoj račun i lozinku, i kliknite "Sign in "

© odaberite željeni klimatski uređaj kako bi ga nadodali u izbornik za upravljanje.



© na taj način korisnik može kontrolirati uključivanje/isključivanje klima uređaja, način rada, brzinu ventilatora itd.

### **NAPOMENA:**

Pomoću ove aplikacije nisu dostupne sve funkcije klimatskog uređaja.npr. ECO, Turbo, puhanje lijevo/desno, i gore/dolje. Za više informacija molimo vas pogledajte uputstva za uporabu.

## 7 POSEBNE FUNKCIJE

Uključuju: Timer uključivanja, Timer isključivanja, 8°C temperatura grijanja, spavanje, štednja, provjera.

**NAPOMENA:** ako klimatski uređaj nema iznad navedene mogućnost, ta se funkcija neće ni nalaziti na popisu mogućnosti.

### ■ Timer uključivanja/isključivanja

Na tjednoj bazi korisnik može podesiti Timer da se klimatski uređaj uključuje/isključuje u isto vrijeme. Također može koristiti "circulation" da se te radnje svakodnevno ponavljaju.

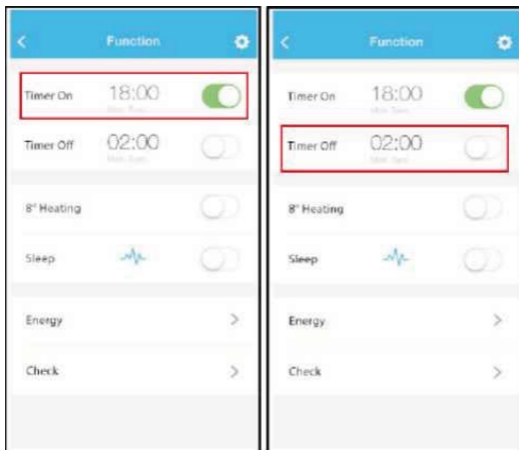

< Timer On OK

07	48
08	49
10	50
11	51
12	52

Repeat Mon, Tue

< Repeat

Monday	<input checked="" type="checkbox"/>
Tuesday	<input checked="" type="checkbox"/>
Wednesday	<input type="checkbox"/>
Thursday	<input type="checkbox"/>
Friday	<input type="checkbox"/>
Saturday	<input type="checkbox"/>
Sunday	<input type="checkbox"/>

## ■ 8°C temperatura grijanja

Korisnik može namjestiti klimu na 8°C samo jednim klikom, tako da kada ljudi napuste prostoriju pomoću ove funkcije štiti se namještaj od oštećenja nastalih smrzavanjem.



## ■ Stanje mirovanja

Korisnik može podesiti rad uređaja za vrijeme spavanja.

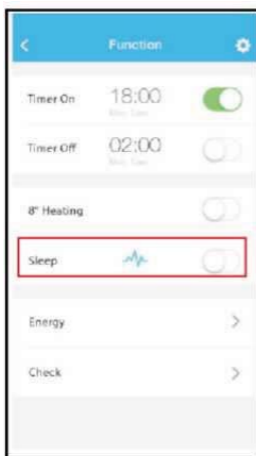

## ■ Provjera

Korisnik može jednostavno, pritiskom jednog gumba provjeriti status klimatskog uređaja pomoću ove funkcije. Kada dovrši provjeru može prikazati normalne, nenormalne i detaljne informacije.

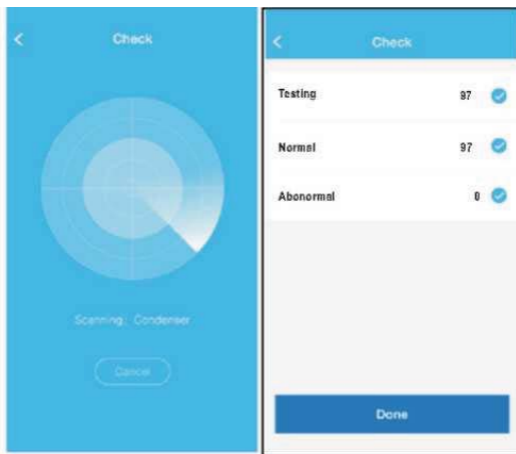



## Detail

Abnormal: 0

Normal: 97

Compressor frequency

Compressor current

Outdoor machine current

Evaporator temperature

Condenser temperature

Exhaust temperature

Outdoor temperature

## I Energija

Korisnik može na mjesečnoj bazi vidjeti krivulju potrošnje energije, te najveću i najmanju potrošnju.

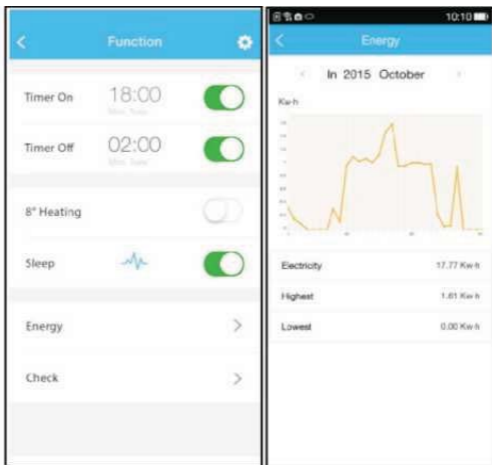

## Odlaganje u otpad stare električne i elektroničke opreme



Proizvodi označeni ovim simbolom označavaju da proizvod spada u grupu električne i elektroničke opreme (EE proizvodi) te se ne smije odlagati zajedno s kućnim i glomaznim otpadom. Zbog toga ovaj proizvod treba odložiti na označeno sabirno mjesto za prikupljanje električne i elektroničke opreme. Pravilnim odlaganjem ovog proizvoda pomoći ćete spriječiti moguće negativne posljedice na okoliš i ljudsko zdravlje, koji bi inače mogli biti ugroženi neodgovarajućim odlaganjem istrošenog proizvoda. Recikliranjem materijala pomoći ćemo sačuvati zdravi životni okoliš i prirodne resurse.

Za detaljne informacije o sakupljanju EE proizvoda obratite se M SAN Grupi ili prodavaonici u kojoj ste kupili ovaj proizvod. Više informacija možete pronaći na [www.elektrootpad.com](http://www.elektrootpad.com) i [info@elektrootpad.com](mailto:info@elektrootpad.com) te pozivom na broj 062 606 062 .

## Odlaganje baterije u otpad



Provjerite lokalne propise u vezi s odlaganjem baterija ili nazovite lokalnu službu za korisnike za upute o odlaganju stare baterije.

Ova baterija ne smije se bacati zajedno s kućnim otpadom. Ako je moguće, koristite posebna mjesta za odlaganje iskorištenih baterija koja se nalaze na svim prodajnim mjestima gdje možete kupiti baterije.

## Obavijest o Izjavi o sukladnosti :

Izjavu o sukladnosti i presliku izvorne Izjave sukladnosti (EC Declaration of Conformity) možete jednostavno preuzeti na našoj internetskoj stranici [www.msan.hr/dokumentacijaaartikala](http://www.msan.hr/dokumentacijaaartikala).

## USER MANUAL OF SMART AC

NOTE:

Company will not be liable for any issues and problems caused by Internet, Wi-Fi Router and Smart Devices. Please contact the original provider to get further help.



CS374U-APP(OSK102)  
16122000002774  
20151116

# CONTENTS

1	DECLARATION OF CONFORMITY.....	1
2	SPECIFICATION.....	1
3	PRECAUTIONS .....	1
4	TECHNICAL SOLUTION .....	2
5	OPERATION INSTRUCTION .....	4
6	HOW TO USE APP .....	13
7	SPECIAL FUNCTIONS .....	15

## CAUTIONS

- This device complies with Part 15 of the FCC Rules and RSS 210 of Industry & Science Canada. Operation is subject to the following two conditions: (1) this device may not cause harmful interference, and (2) this device must accept any interference received, including interference that may cause undesired operation.
- Only operate the device in accordance with the instructions supplied. This device complies with FCC and IC radiation exposure limits set forth for an uncontrolled environment. In order to avoid the possibility of exceeding the FCC and IC radio frequency exposure limits, human proximity to the antenna shall not be less than 20cm (8 inches) during normal operation.
- Changes or modifications not expressly approved by the party responsible for compliance could void the user's authority to operate the equipment.

## **1** DECLARATION OF CONFORMITY

Hereby, we declare that this AC is in compliance with the essential requirements and other relevant provisions of Directive 1999/5/EC. The declaration of conformity may be consulted with sales agent.

## **2** SPECIFICATION

**Model:** OSK102

**Standard:** IEEE 802.11b/g/n

**Antenna Type:** Wxternal omnidirectional Antenna.

**Frequency:** WIFI: 2.4G

**Maximum Transmitted Power:** 15dBm Max

**Dimension:** 55\*24\*8(mm)

**Operation Temperature:** 0°C~45°C/32°F~113°F.

**Operation Humidity:** 10%~85%

**Power Input:** DC 5V/300mA

## **3** PRECAUTIONS

- Applicable system :IOS, Android.  
(Suggest:IOS 7.0 or later Android 4.0 or later)  
Please check the service website for more applicable devices.
- Disclaimer:Due to the special situation existed during App use,we explicitly claim as bellow:  
Not all of the Android and IOS systems are compatible with the APP.We will not be responsible for any issue as a result of the incompatibility SMART KIT wireless safety strategy.  
Smart kit Only support WPA-PSK/WPA2-PSK encryption and none encryption .  
WPA-PSK/WPA2-PSK encryption is recommended.

- Smart Phone camera needs to be 5 million pixels or above to make sure scan QR code well.
- Due to different network situation, sometimes, request time-out could be happened, thus, it is necessary to do network configuration again.

Due to different network situation, sometimes, control process may return time out. If this situation occurs, do not feel confused, the display on board and APP may not be the same.

#### 4. TECHNICAL SOLUTION

1. WIFI Router Home Control Mode.

A WIFI router is needed at this mode. Smart phone and connect to the AC through the WIFI router conditioner.

- 1 ) Smart Phone
- 2 ) Smart Air conditioner
- 3 ) WIFI Router

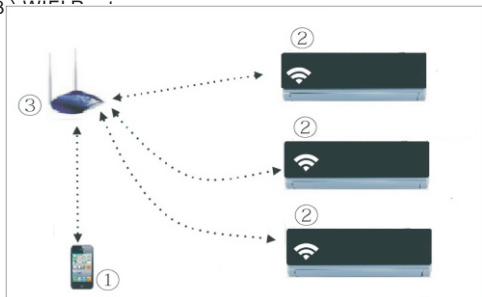

2

2. How to install the smart kit

- ① Remove the protective cap of the smart kit

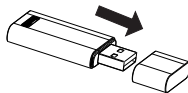

- ② Open the front panel and insert the smart kit into the reserved port
- ③ Attach the QR code packed with SMART KIT to the side panel of the machine, ensure it is convenient to be scanned by the mobile phone.

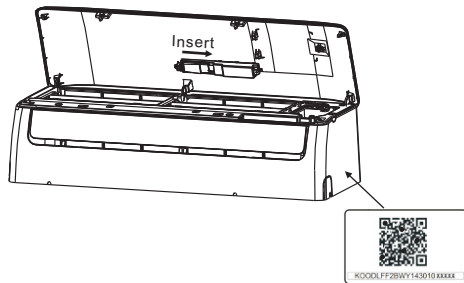

3

## 5 OPERATION INSTRUCTION

### 1.Install App

- 1).**iPhone Users**:scan QR Code or go to App Store and search for 'NetHome Plus' app and download it.
- 2).**Android Phone users**:scan QR Code or go to google play, search for 'NetHome Plus' app and download it

### 2.Set Air conditioner to be AP mode

The procedure includes the following steps:

- 1) Disconnect the power supply of AC
- 2) Connect the power supply of AC, and continuously press the digital display button or do not disturb button seven times in 3 minutes.
- 3) When the AC displays 'AP', it means that the AC WIFI has already entered into the WIFI Network Setting Mode.

#### Kindly reminder:

- When the AC WIFI entered into WIFI Network Setting Mode, the Air-conditioning remote control can't open the AC. It needs to wait 3-5 minutes or when the AC finishes the WIFI Network Setting Mode, then the Air-conditioning remote control can control AC normally.
- If there is no set operation under WIFI Network setting mode,AC will quit this mode automatically 8 minutes later ,and then the user can control the AC normally.

4

### 3.User Registration and Network Configuration

- Please ensure your mobile device is connected to Wifi router. Also, the Wifi router has already connected to Internet before doing user registration and network configuration.



① Click 'Creat Account'

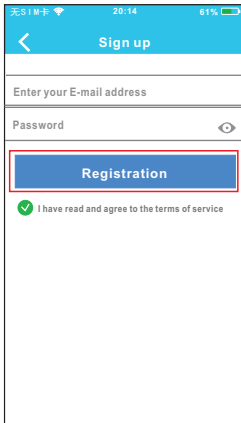

② Enter your email address and password, and then click 'Registration'.

5

### CAUTION:

- It is better to log in your email box and active your registration account by clicking link in case you forget the password.
  - It is necessary to forget any other around network and make sure the Android or IOS device just connect to the WIFI network you want to configure.
  - Make sure the Android or IOS device WIFI function works well and can be connected back to your original WIFI network automatically.
- Using Android device to do Network configuration

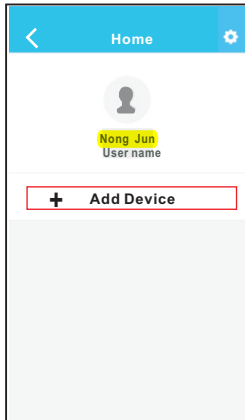

③ Press '+ Add Device'



④ Scan QR Code

6

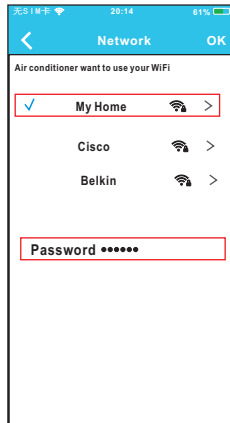

⑤ Select your own WiFi network, for example My Home (the picture is only for reference)

⑥ Enter your own WiFi router password and click OK;

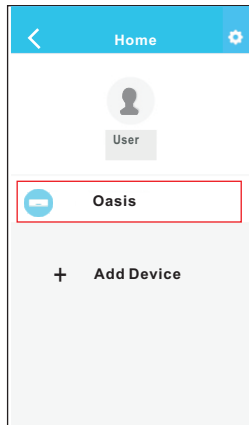

⑦ Configuration Success, you can see the device on the list.

7

## Using IOS device to do Network configuration

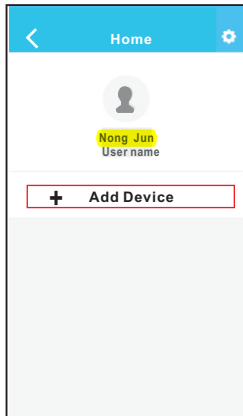

③ Press '+ Add Device'

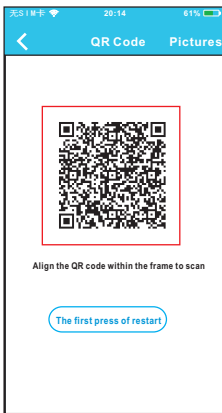

④ Scan QR Code

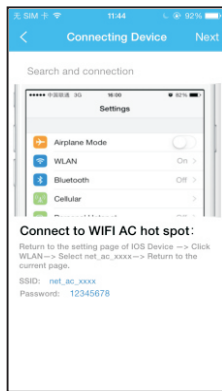

⑤ Read the instruction above and press the 'Home' button to return to the device interface.

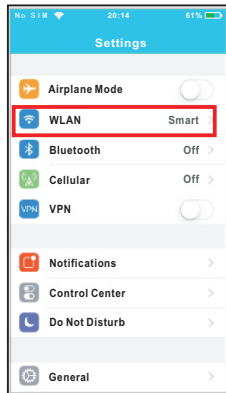

⑥ Click settings to enter the setting page, select WLAN/WIFI.



⑦ Choose net\_ac\_XXXX

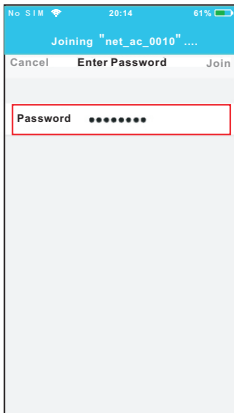

⑧ Type default password:  
12345678 and click  
"Join "

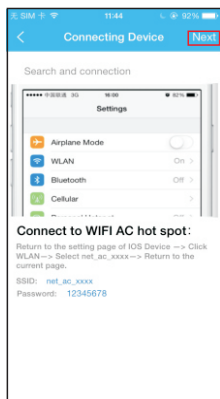

⑨ Return to APP and  
click Next

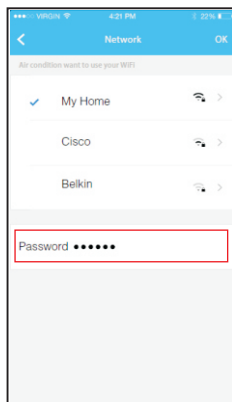

⑩ Select your own WiFi  
network, for example  
My Home (the picture  
is only for reference)

⑪ Enter your own WiFi  
router password and  
click OK;

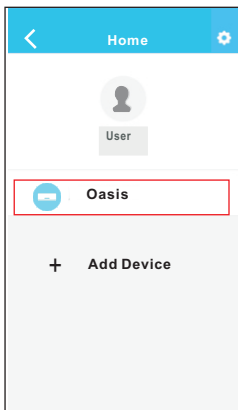

⑫ Configuration Success, you can see the device on the list.

## NOTE:

When finishing network configuration, APP will display success cue words on the screen. Due to different Internet environment, it is possible that the device status still display "offline". If this situation occurs, user should turn off the AC power and turn on it again. After a few minutes, it is necessary to do pull-refresh operation to make sure the device status become "online".

⑫

## 6 HOW TO USE APP

Please ensure both your mobile device and air conditioner are connected to the Internet before using app to control the air conditioner via internet, please follow the next steps:

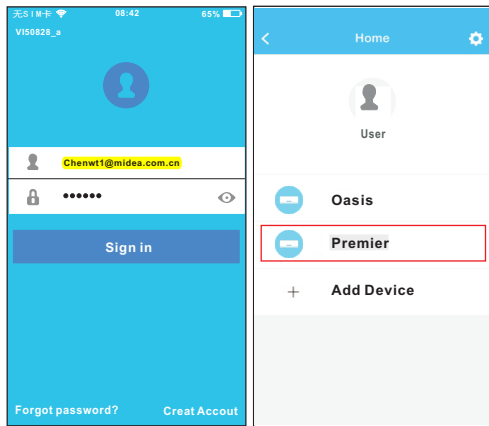

① Type your own account and password, Click "Sign in"

② Select the target air conditioner to enter into the main control interface.

⑬



- ③ Thus, user can control air conditioners on/off status, operation mode, temperature, fan speed and so on.

### NOTE:

Not all the function of the APP is available on air conditioner. For example: ECO, Turbo, Left and Right Swing, Up and Down swing function, please check the user manual to find more information.

## 7 SPECIAL FUNCTIONS

Including: Timer on, Timer off, 8°C Heat, Sleep, Energy, Check.

**NOTE:** If the air conditioner do not support the above function, the function will be hidden from the function list.

### ■ Timer on/ Timer off

Weekly, user can make an appointment to turn on or off AC on specific time. User also can choose circulation to keep the AC under schedule control every week.

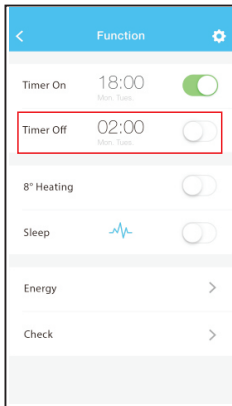
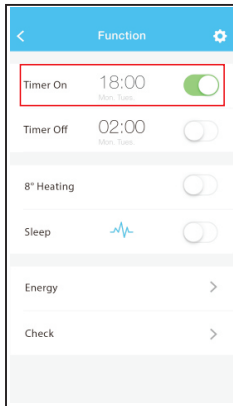

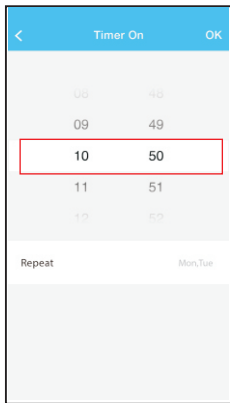

16

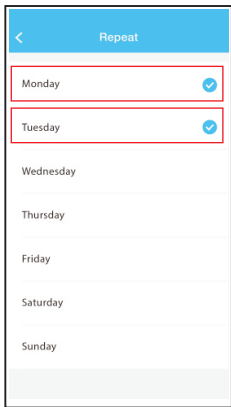

## ■ 8°C Heat

User can let the AC run under 8°C Heat by one-click. When people go outside, this function can protect your furniture from frost damage.

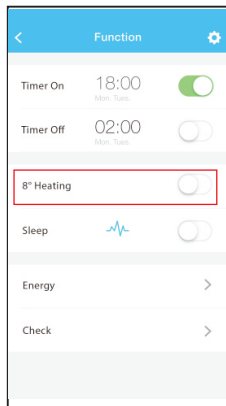

17

## ■ Sleep

User can customize their own comfortable sleep by setting target temperature.

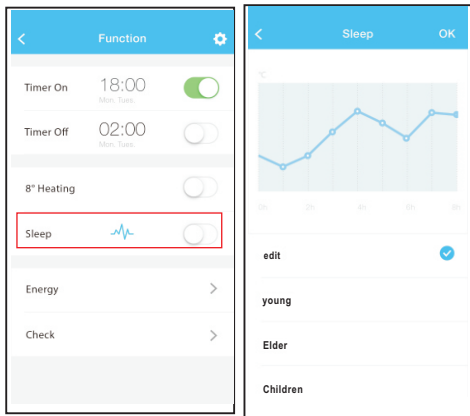

## ■ Check

User can simply check the AC running status with this function. When finishing this procedure, it can display the normal items, abnormal items, and detail information.

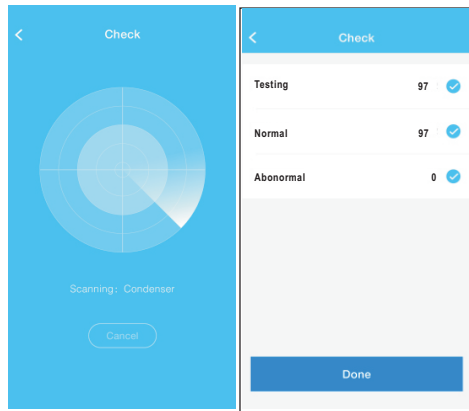

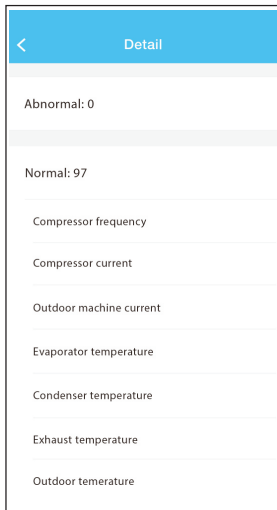

## ■ Energy

User can see the electricity curve monthly, and find the Lowest and highest cost per month.

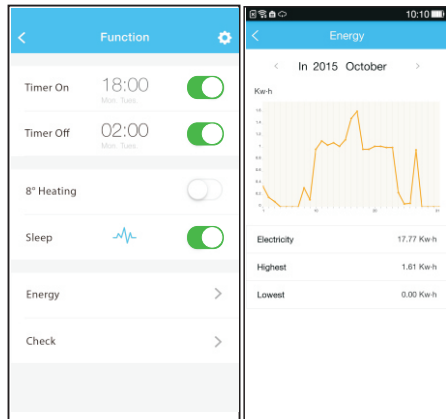



**VIVAX**

[www.VIVAX.com](http://www.VIVAX.com)